



FLORESTA

3 & 4 BHK Residential Apartments

WHERE MODERN
COMFORT AND
TIMELESS LUXURY
CONVERGE IN A
MASTERPIECE
OF LIVING.





Floresta is a tribute to nature and offers a fresh outlook on exclusive living with intelligent design and luxurious indulgences. Step inside a haven that exudes charm and serenity as Floresta is embellished with bountiful green spaces and water bodies that offer a refreshing connection to nature.

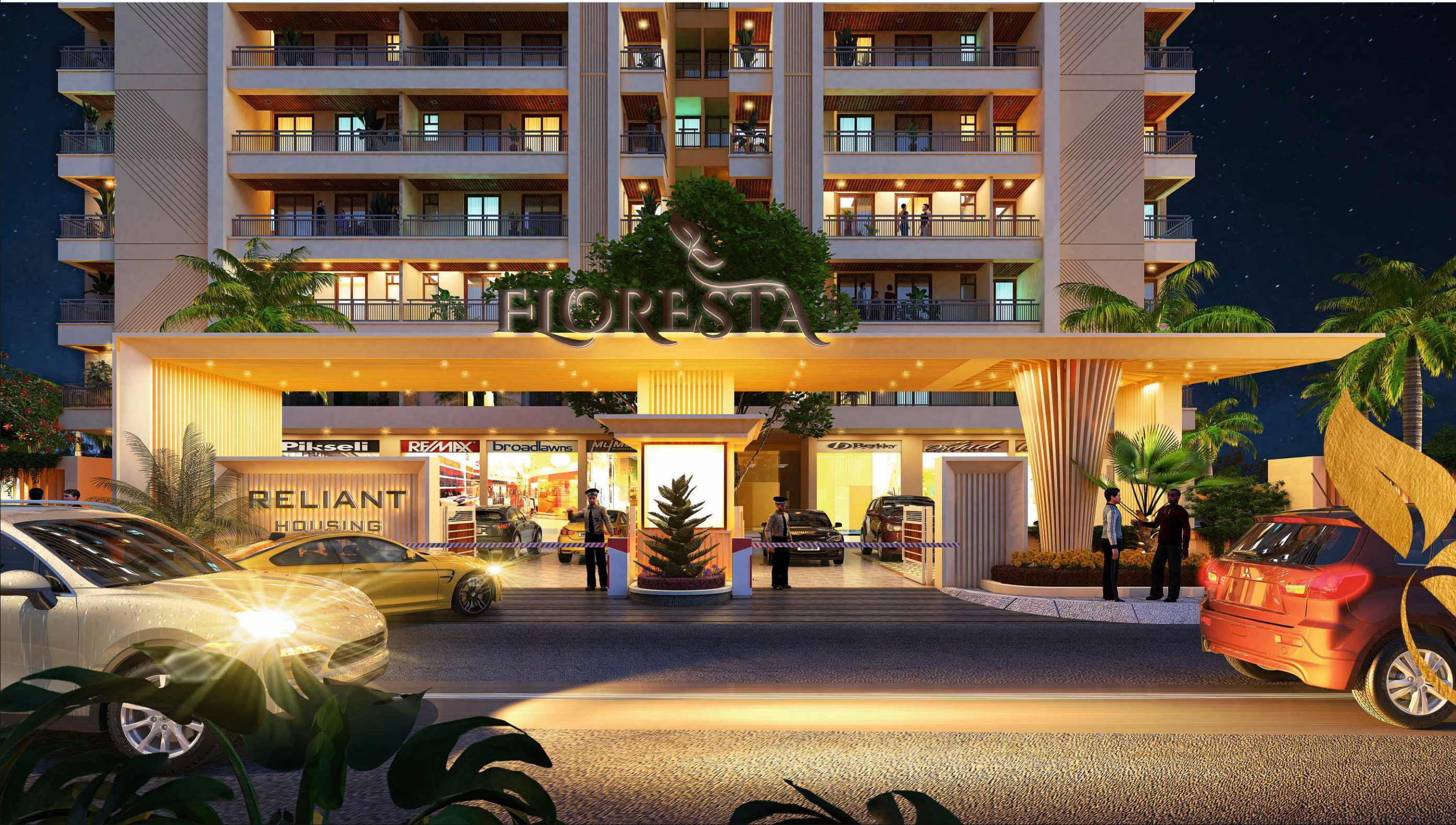

COME HOME TO SERENE WAY OF LIFE

Floresta houses intelligently planned residences that centres around a holistic lifestyle for all age group and where you can live in harmony with nature.

- ☑ The project offers a various recreational indulgences that is suited for every residents needs.
- ☑ Located in Jaipur's one of the most coveted locations for easy convenience and access to prominent places.
- ☑ The verdant landscape exudes a lively environment and serenity.

Experience the ultimate luxury living at Floresta!

204 Flats | Lush Green | Prime | Swimming Pool
3 & 4 BHK | Spaces | Location | @ Terrace



A WELCOME
 to your everyday
 extraordinary lifestyle



Our expertly crafted entrance lobby sets the tone for a life of unrivalled luxury and sophistication. From the moment you enter, you will be immersed in an atmosphere of sophisticated elegance and comfort, leaving a lasting sense of the extraordinary living that awaits you.



 Centrally AC
 Entrance Lobby



MORE TO LIVING

Inspired by nature, Floresta is more than four walls, it is a sanctuary where you reside amongst nature and embrace a life that is both luxurious and serene. The central water body and vibrant green surroundings creates a visual treat as well as a calming experience after a hectic day at work to spend some quality time with family.



Podium Garden



Indoor Games



Jogging Track





FLORESTA

3 & 4 BHK Residential Apartments



Work From Home Space



Business Lounge



Guest Rooms





ELEVATED
MOMENTS
OF LIFE @Floresta



Senior Citizen Corner

Welcome to Floresta, a masterfully planned residential community where elegance and tranquility coexist.

- ☑ A verdant haven full of vibrant blossoms and abundant greenery
- ☑ Senior Citizen Area that offers a calm and secure setting with cozy seating
- ☑ Kids play area is a lively, safe area with lots of fascinating play equipment
- ☑ Community Hall for get-togethers, festivities, and activities



Community Hall



LIKE

A BREATH OF
FRESH AIR



Mini Theatre



CCTV Camera



Gas Pipe Lines



Sewerage Treatment Plant



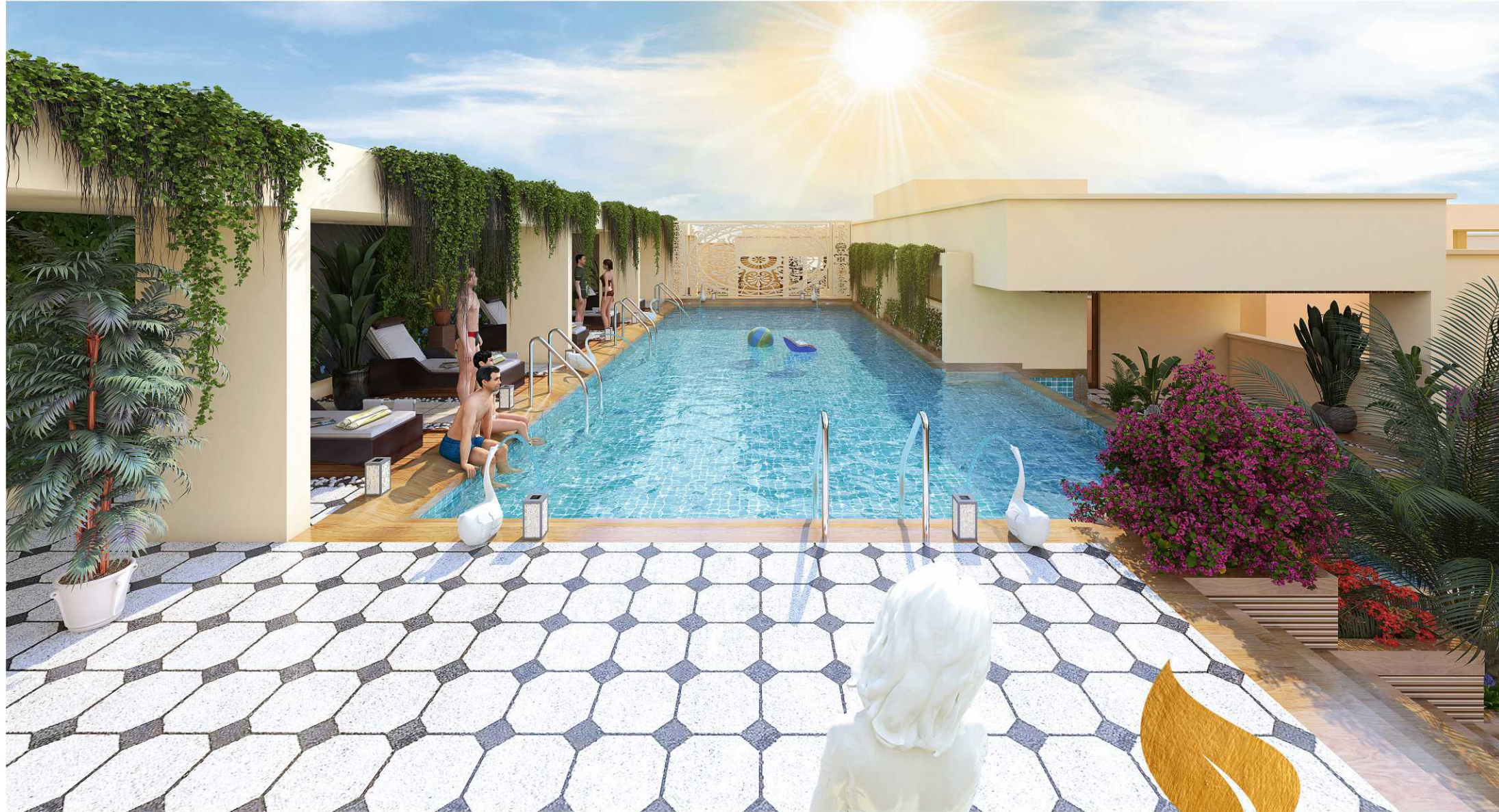

EXPERIENCE

extraordinary everywhere @Floresta

Floresta takes luxury living to new heights with a variety of world-class facilities tailored to your every need.

- ☑ Dive into relaxation at our immaculate swimming pool
- ☑ Maintain your fitness and activity levels in our cutting-edge gymnasium
- ☑ Watch the newest blockbusters in the luxury of your own private cinema
- ☑ Indoor games section has a range of activities to keep you occupied



Swimming Pool





 **FEEL**
The adrenaline rush with every workout



 **UNLEASH**
Joy with every playful moment





 **ESCAPE**
into a realm of literary elegance



 **TRANSFORM**
your routine with elevated workouts





LIVING
BECOMES
A TRUE DELIGHT

-  Rain Water Harvesting
-  Stilt/Open/Basement Parking
-  Solar Panel





DISCOVER THE
shades of peace @ Floresta

Floresta brings you closer to nature with its wonderfully constructed terrace garden, which has a tranquil sitting space surrounded by lush flora. The terrace garden is a haven of peace where residents may relax and unwind among bright greenery. Furthermore, the garden space on the ground floor has a finely groomed path excellent for cycling, allowing you to enjoy the outdoors from the comfort of your own home. Floresta offers the right combination of luxury and nature, with every detail designed to improve your living experience.

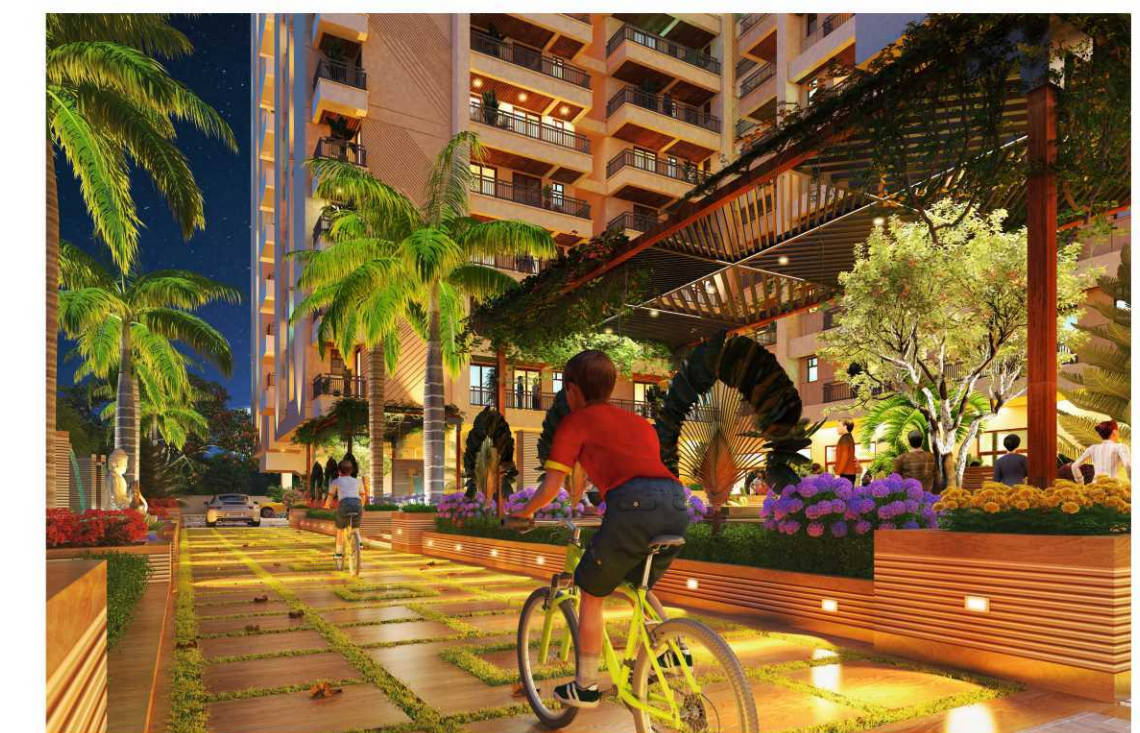



 FIND THE 'ME TIME'
you've always been missing



ROOF TOP SITTING



 IMMERSE IN THE
best of nature all under one roof



GAZEBO SITTING



FLORESTA
3 & 4 BHK Residential Apartments



BETTER PLANS

@ Floresta

Legends

- 01 Entrance Lobby
- 02 Community Hall
- 03 Podium Landscape Area
- 04 Kids Play Area
- 05 Gym
- 06 Elder Lounge
- 07 Library
- 08 Society Office
- 09 Mini Theatre
- 10 Parking
- 11 Shops
- 12 Landscape Garden
- 13 Water Bodies

STILT FLOOR PLAN



FIRST FLOOR PLAN

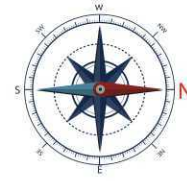

BLOCK - A



BLOCK - B



BLOCK -A AREA STATEMENT

Flat No.	Type	Sale Area (in Sq.ft.)	Builtup Area (in Sq.ft.)	Carpet Area (in Sq.ft.)	Balcony Area (in Sq.ft.)
01	4 BHK	2282.00	1629.54	1319.11	243.49
02	3 BHK	1700.00	1213.29	1017.81	158.24
03	3 BHK	1700.00	1214.29	1012.86	162.22
04	4 BHK	2112.00	1508.58	1273.47	180.20
05	4 BHK	2197.00	1568.98	1310.29	209.05
06	3 BHK	1772.00	1265.16	1027.28	199.14
07	3 BHK	1863.00	1330.61	1088.21	147.69
08	3 BHK	1725.00	1231.95	993.80	191.50
09	3 BHK	1690.00	1207.59	967.64	186.66

BLOCK -B AREA STATEMENT

Flat No.	Type	Sale Area (in Sq.ft.)	Builtup Area (in Sq.ft.)	Carpet Area (in Sq.ft.)	Balcony Area (in Sq.ft.)
01	3 BHK	1652.00	1180.02	966.24	171.69
02	3 BHK	1788.00	1276.57	1036.21	191.29
03	3 BHK	1868.00	1333.94	1046.12	228.21
04	3 BHK	1752.00	1251.33	1013.64	200.33
05	4 BHK	2244.00	1602.80	1360.13	195.05
09	3 BHK	1611.00	1150.58	984.22	114.86
10	3 BHK	1833.00	1309.31	1061.94	198.17
11	3 BHK	1654.00	1180.98	966.46	171.69

SECOND FLOOR PLAN

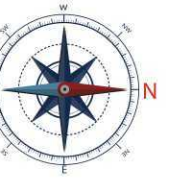

BLOCK - A



BLOCK - B



BLOCK -A AREA STATEMENT

Flat No.	Type	Sale Area (in Sq.ft.)	Builtup Area (in Sq.ft.)	Carpet Area (in Sq.ft.)	Balcony Area (in Sq.ft.)
01	4 BHK	2282.00	1629.54	1319.11	243.49
02	3 BHK	1700.00	1213.29	1017.81	158.24
03	3 BHK	1700.00	1214.29	1012.86	162.22
04	4 BHK	2112.00	1508.58	1273.47	180.20
05	4 BHK	2197.00	1568.98	1310.29	209.05
06	3 BHK	1772.00	1265.16	1027.28	199.14
07	3 BHK	1863.00	1330.61	1088.21	147.69
08	3 BHK	1725.00	1231.95	993.80	191.50
09	3 BHK	1690.00	1207.59	967.64	186.66

BLOCK -B AREA STATEMENT

Flat No.	Type	Sale Area (in Sq.ft.)	Builtup Area (in Sq.ft.)	Carpet Area (in Sq.ft.)	Balcony Area (in Sq.ft.)
01	3 BHK	1652.00	1180.02	966.24	171.69
02	3 BHK	1788.00	1276.57	1036.21	191.29
03	3 BHK	1868.00	1333.94	1046.12	228.21
04	3 BHK	1752.00	1251.33	1013.64	200.33
05	4 BHK	2244.00	1602.80	1360.13	195.05
09	3 BHK	1611.00	1150.58	984.22	114.86
10	3 BHK	1833.00	1309.31	1061.94	198.17
11	3 BHK	1654.00	1180.98	966.46	171.69

TYPICAL (Third to Eleventh) FLOOR PLAN



BLOCK - A

BLOCK - B



BLOCK - A AREA STATEMENT

Flat No.	Type	Sale Area (in Sq.ft.)	Builtup Area (in Sq.ft.)	Carpet Area (in Sq.ft.)	Balcony Area (in Sq.ft.)
01	4 BHK	2282.00	1629.54	1319.11	243.49
02	3 BHK	1700.00	1213.29	1017.81	158.24
03	3 BHK	1700.00	1214.29	1012.86	162.22
04	4 BHK	2112.00	1508.58	1273.47	180.20
05	4 BHK	2197.00	1568.98	1310.29	209.05
06	3 BHK	1772.00	1265.16	1027.28	199.14
07	3 BHK	1863.00	1330.61	1088.21	147.69
08	3 BHK	1725.00	1231.95	993.80	191.50
09	3 BHK	1690.00	1207.59	967.64	186.66

BLOCK - B AREA STATEMENT

Flat No.	Type	Sale Area (in Sq.ft.)	Builtup Area (in Sq.ft.)	Carpet Area (in Sq.ft.)	Balcony Area (in Sq.ft.)
01	3 BHK	1652.00	1180.02	966.24	171.69
02	3 BHK	1788.00	1276.57	1036.21	191.29
03	3 BHK	1868.00	1333.94	1046.12	228.21
04	3 BHK	1752.00	1251.33	1013.64	200.33
05	4 BHK	2244.00	1602.80	1360.13	195.05
06	1 BHK	491.52	303.99	25.40	25.40
07	2 BHK	941.00	574.40	71.58	71.58
08	2 BHK	1015.12	579.03	112.06	112.06
09	3 BHK	1611.00	1150.58	984.22	114.86
10	3 BHK	1833.00	1309.31	1061.94	198.17
11	3 BHK	1654.00	1180.98	966.46	171.69

TWELFTH FLOOR PLAN

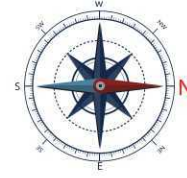

BLOCK - A



BLOCK - A AREA STATEMENT

Flat No.	Type	Sale Area (in Sq.ft.)	Builtup Area (in Sq.ft.)	Carpet Area (in Sq.ft.)	Balcony Area (in Sq.ft.)
01	4 BHK +T	2282.00	1629.54	1319.11	243.49
02	3 BHK +T	1698.00	1213.29	1017.81	158.24
03	3 BHK +T	1700.00	1214.29	1012.86	162.22
04	4 BHK +T	2112.00	1508.58	1273.47	180.20
05	4 BHK +T	2197.00	1568.98	1310.29	209.05
06	3 BHK +T	1772.00	1265.16	1027.28	199.14
07	3 BHK	1863.00	1330.61	1088.21	147.69
08	3 BHK	1725.00	1231.95	993.80	191.50
09	3 BHK	1690.00	1207.59	967.64	186.66

BLOCK - B



BLOCK - B AREA STATEMENT

Flat No.	Type	Sale Area (in Sq.ft.)	Builtup Area (in Sq.ft.)	Carpet Area (in Sq.ft.)	Balcony Area (in Sq.ft.)
01	3 BHK	1652.00	1180.02	966.24	171.69
02	3 BHK	1788.00	1276.57	1036.21	191.29
03	3 BHK	1868.00	1333.94	1046.12	228.21
04	3 BHK+T	1752.00	1251.33	1013.64	200.33
05	4 BHK+T	2244.00	1602.80	1360.13	195.05
06	1 BHK	491.52		303.99	25.40
07	2 BHK	941.00		574.40	71.58
08	2 BHK	1015.12		579.03	112.06
09	3 BHK	1611.00	1150.58	984.22	114.86
10	3 BHK+T	1833.00	1309.31	1061.94	198.17
11	3 BHK+T	1654.00	1180.98	966.46	171.69

TERRACE FLOOR PLAN

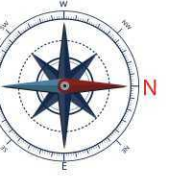



UNIT TYPE
A-1

Sale Area	2282.00 Sq. Ft.
Built-up Area	1629.54 Sq. Ft.
Carpet Area	1319.11 Sq. Ft.
Balcony Area	243.49 Sq. Ft.

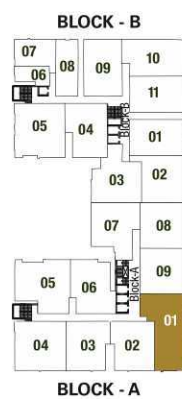

UNIT TYPE
A-2

Sale Area	1700.00 Sq. Ft.
Built-up Area	1213.29 Sq. Ft.
Carpet Area	1017.81 Sq. Ft.
Balcony Area	158.24 Sq. Ft.

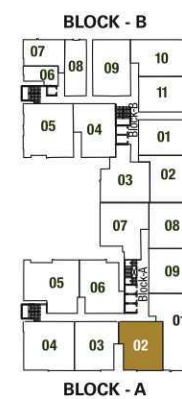

UNIT TYPE
A-3

Sale Area	1700.00 Sq. Ft.
Built-up Area	1214.26 Sq. Ft.
Carpet Area	1012.86 Sq. Ft.
Balcony Area	162.22 Sq. Ft.

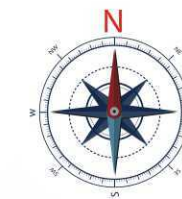

UNIT TYPE
A-4

Sale Area	2112.00 Sq. Ft.
Built-up Area	1508.58 Sq. Ft.
Carpet Area	1273.47 Sq. Ft.
Balcony Area	180.20 Sq. Ft.

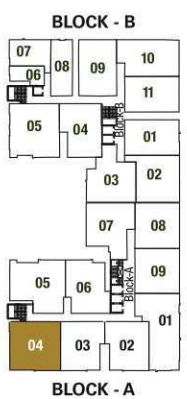



UNIT TYPE A-5

Sale Area	2197.00 Sq. Ft.
Built-up Area	1568.98 Sq. Ft.
Carpet Area	1310.29 Sq. Ft.
Balcony Area	209.05 Sq. Ft.

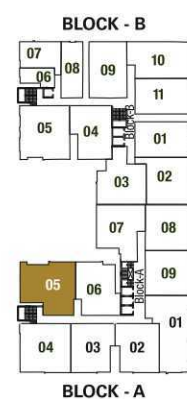

UNIT TYPE A-6

Sale Area	1772.00 Sq. Ft.
Built-up Area	1265.16 Sq. Ft.
Carpet Area	1027.28 Sq. Ft.
Balcony Area	199.14 Sq. Ft.

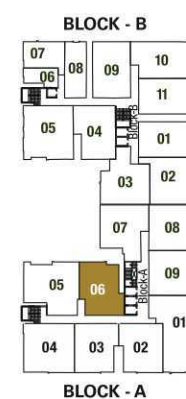

UNIT TYPE A-7

Sale Area	1863.00 Sq. Ft.
Built-up Area	1330.61 Sq. Ft.
Carpet Area	1088.21 Sq. Ft.
Balcony Area	147.69 Sq. Ft.

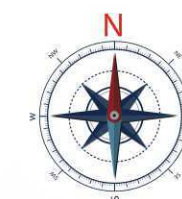

UNIT TYPE A-8

Sale Area	1725.00 Sq. Ft.
Built-up Area	1231.95 Sq. Ft.
Carpet Area	993.80 Sq. Ft.
Balcony Area	191.50 Sq. Ft.





**UNIT TYPE
A-9**

Sale Area	1690.00 Sq. Ft.
Built-up Area	1207.59 Sq. Ft.
Carpets Area	967.64 Sq. Ft.
Balcony Area	186.66 Sq. Ft.





UNIT TYPE
B-1

Sale Area	1652.00 Sq. Ft.
Built-up Area	1180.02 Sq. Ft.
Carpet Area	966.24 Sq. Ft.
Balcony Area	171.69 Sq. Ft.

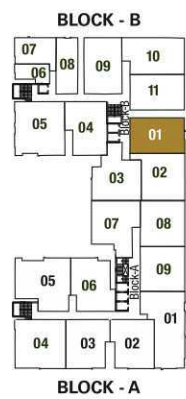

UNIT TYPE
B-2

Sale Area	1788.00 Sq. Ft.
Built-up Area	1276.57 Sq. Ft.
Carpet Area	1036.21 Sq. Ft.
Balcony Area	191.29 Sq. Ft.



UNIT TYPE
B-3

Sale Area	1868.00 Sq. Ft.
Built-up Area	1333.94 Sq. Ft.
Carpet Area	1046.12 Sq. Ft.
Balcony Area	228.21 Sq. Ft.



UNIT TYPE
B-4

Sale Area	1752.00 Sq. Ft.
Built-up Area	1251.33 Sq. Ft.
Carpet Area	1013.64 Sq. Ft.
Balcony Area	200.33 Sq. Ft.

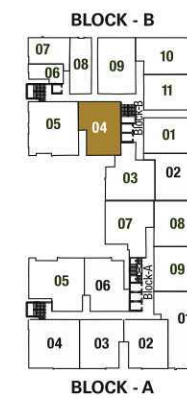



UNIT TYPE
B-5

Sale Area	2244.00 Sq. Ft.
Built-up Area	1602.80 Sq. Ft.
Carpet Area	1360.13 Sq. Ft.
Balcony Area	195.05 Sq. Ft.

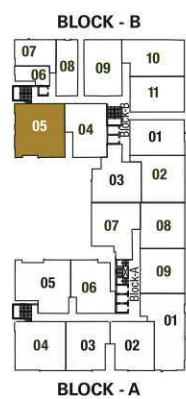

UNIT TYPE
B-6

Sale Area	491.52 Sq. Ft.
Carpet Area	303.99 Sq. Ft.
Balcony Area	25.40 Sq. Ft.

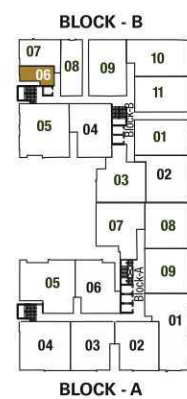

UNIT TYPE
B-7

Sale Area	941.70 Sq. Ft.
Carpet Area	574.40 Sq. Ft.
Balcony Area	71.58 Sq. Ft.

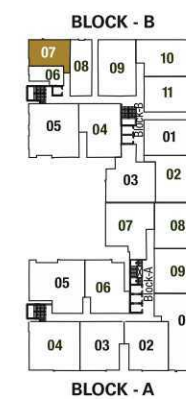

UNIT TYPE
B-8

Sale Area	1015.12 Sq. Ft.
Carpet Area	579.03 Sq. Ft.
Balcony Area	112.06 Sq. Ft.

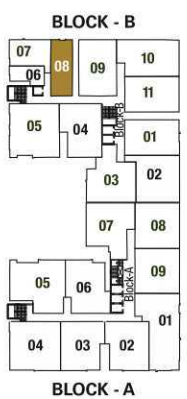

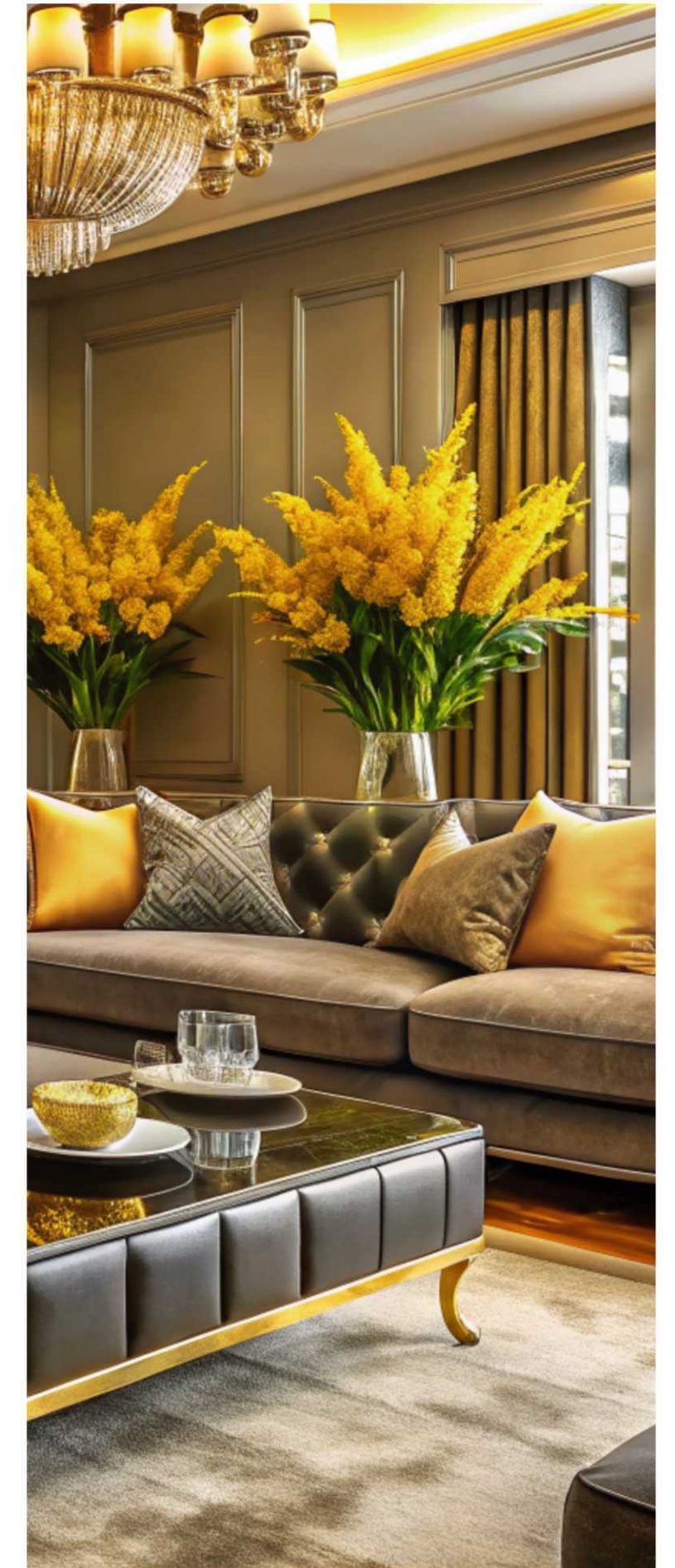

UNIT TYPE
B-9

Sale Area	1611.00 Sq. Ft.
Built-up Area	1150.58 Sq. Ft.
Carpet Area	984.22 Sq. Ft.
Balcony Area	114.86 Sq. Ft.

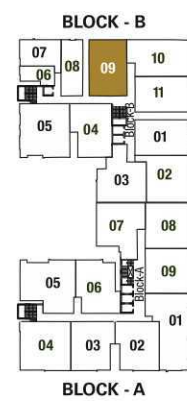

UNIT TYPE
B-10

Sale Area	1833.00 Sq. Ft.
Built-up Area	1309.31 Sq. Ft.
Carpet Area	1061.94 Sq. Ft.
Balcony Area	198.17 Sq. Ft.

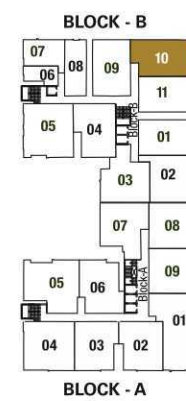

UNIT TYPE
B-11

Sale Area	1654.00 Sq. Ft.
Built-up Area	1180.98 Sq. Ft.
Carpet Area	966.46 Sq. Ft.
Balcony Area	171.69 Sq. Ft.

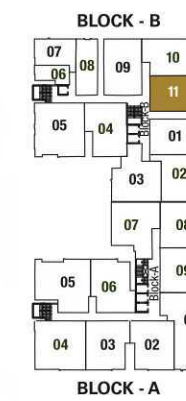



SPECIFICATIONS

SAFETY

- ◉ Earthquake Resistant RCC Frame Structure as per design
- ◉ Fire Fighting System on Every Floor According to Norms
- ◉ 100% Usage of ISI Standard Steel
- ◉ Railing: Standard quality MS Railing

FLOORING

- ◉ Italian Marble Flooring in Entrance Lobby
- ◉ Premium Quality Vitrified Tiles
- ◉ Granite/Full Body Vitrified flooring in Lift Lobby/Staircase
- ◉ 600*1200 vitrified tile flooring in Apartments
- ◉ 600*1200 (size as per availability) Matt Finish Vitrified Tile Flooring in Toilets

DOORS & WINDOWS

- ◉ Three Track External windows of UPVC/Aluminium Frames of Premium quality Brand
- ◉ Teak Wood/Stone Finished Frames for Internal & External Doors
- ◉ Both Side laminated finish wooden doors of premium quality brand
- ◉ Premium Quality hardware & Fittings with SS Finish of Dorset/Yale or equivalent

PAINT

- ◉ Internal Walls and Ceilings with smooth POP finish in Drawing/Dining & Rooms
- ◉ Internal: Premium Quality Paint
- ◉ External: Deluxe Weather Shield/Asian Apex Ultima or Equivalent

KITCHEN

- ◉ Kitchen with Full Body Vitrified Tile/Granite Counter Top
- ◉ Wall Cladding above cooking counter upto 2 Ft. Height
- ◉ Stainless Steel Kitchen Sink of Premium Quality
- ◉ Gas Supply Connected to Apartments

TOILETS

- ◉ 600*1200 Vitrified Tiles on wall upto False Ceiling height
- ◉ Astral or Equivalent Plumbing Fittings
- ◉ Premium Brand CP fittings of Jaguar/Hindware or Equivalent Brand
- ◉ Ceramic Sanitary ware of American Standard or Equivalent
- ◉ Full Body Vitrified Tile/Granite Counter for Wash Basins
- ◉ False Ceiling in Toilets
- ◉ Waterproofing: Premium Quality Branding

ELECTRICAL

- ◉ Modern Electrical System with Concealed Copper Wiring
- ◉ Premium Quality Switches & Accessories
- ◉ Power Back Up in Apartment Provision of Wiring for Inverter Installation
- ◉ Optical Fibre Cable
- ◉ Split A.C. Piping/Wiring in Drawing/Dining/Bed Rooms
- ◉ Power Back Up for Common Area Though Silent DG Set
- ◉ Electrical Vehicle Charging Stations



THE GROUP

Building Trust, Creating Value.

Reliant Group is a trusted and respected name in Jaipur, Rajasthan, renowned for its excellence and innovation in the field of real estate. With a legacy of over a decade, we have successfully delivered more than 10 exceptional projects, each embodying our commitment to quality, sustainability, and customer satisfaction. Our team consists of highly skilled engineers and dynamic directors who bring a wealth of experience and a forward-thinking approach to every project.

At Reliant Group, we believe in creating not just buildings, but vibrant communities that offer a superior living experience. Our projects are characterized by meticulous planning, innovative design, and state-of-the-art construction techniques. We are dedicated to enhancing the lifestyle of our residents by providing them with aesthetically pleasing, functional, and secure living spaces.

Our unwavering commitment to excellence and customer-centric approach has earned us the trust and loyalty of our clients. As we continue to grow and innovate, we remain dedicated to building homes and communities that reflect our core values of integrity, quality, and reliability.

OUR PREVIOUS PROJECTS



Mansarovar, Jaipur



Main Vaishali Nagar, Jaipur



Ajmer Road, Jaipur



Vaishali Nagar, Extension, Jaipur



Mansarovar, Jaipur



Mansarovar, Jaipur

LOCATION



FLORESTA

— 3 & 4 BHK Residential Apartments —
Near Iskcon Temple, Vande Matram Road

Approachable addresses

EDUCATION

- ⊙ Neerja Modi School 5 Km
- ⊙ Modern School 5 Km
- ⊙ ICG Institute of Educational 5 Km
- ⊙ Cambridge Court High School 5 Km
- ⊙ Vardhman International School 5 Km

HEALTH

- ⊙ Saket Hospital 3 Km
- ⊙ Dhanwantri Hospital 4 Km
- ⊙ ManglamPlus Medicity 4 Km
- ⊙ HCG Cancer Hospital 4 Km
- ⊙ Metro Mas Hospital 4 Km

ENTERTAINMENT

- ⊙ EP 7 Km
- ⊙ WTP 9 Km
- ⊙ City Park 4 Km
- ⊙ The Galaxy Cinema 5 Km
- ⊙ INOX Sunny Trade Centre 7 Km



RELIANT HOUSING

Corporate Off : Plot No. 16-B, Scheme 4S,
New Loha mandi Road, Jaipur
Web: www.relianthousing.in

Project Address :
FLORESTA BY RELIANT GROUP
Near ISKCON Temple, Mansarovar Jaipur



C-49, (B-6) Vidya Apartment,
Paras Marg, Bapu Nagar, Jaipur
Ph 0141- 4005506 (O) 9314918766
Email: info.spacegrid@gmail.com



Knowledge and strategy by

Search Abode Pvt Ltd.
D-7, Patrakar Colony, Mansarovar, Jaipur 302 020
Ph. 9983500655
Email id - searchabode.com@gmail.com
Website - www.searchabode.com





RELIANT
HOUSING

Corporate Off : Plot No. 16-B, Scheme 4S,
New Loha mandi Road, Jaipur MOB +91 9057833000
Email. info@relianthousing.in | Web: www.relianthousing.in

Project Address :
FLORESTA BY RELIANT GROUP
Near ISKCON Temple, Mansarovar Jaipur



Architect
**SPACE
GRID**

C-49, (B-6) Vidya Apartment,
Paras Marg, Bapu Nagar, Jaipur
Ph 0141- 4005506 (O) 9314918766
Email: info.spacegrid@gmail.com



Dot 'W' Dash® @ 0141-2221991, +91-98292 31611

